

# Morris County New Jersey

## Solid Waste Management Plan Amendment

**Inclusion of County Concrete Corp.  
Class B Recycling Center for Concrete  
Roxbury Township, New Jersey**

**July 2013**

**Prepared for the  
Morris County Board of Chosen Freeholders**



**Prepared by the  
Morris County Municipal Utilities Authority  
Solid Waste Management Staff**



**MORRIS COUNTY BOARD OF CHOSEN FREEHOLDERS**

Thomas J. Mastrangelo  
*Freeholder Director*

David Scapicchio  
*Deputy Freeholder Director*

Douglas R. Cabana

John Cesaro

Ann F. Grossi

John Krickus

William "Hank" Lyon

**COUNTY ADMINISTRATOR**

John Bonanni

## **Introduction**

The New Jersey Solid Waste Management Act (N.J.S.A. 13:1E-1 *et. seq.*) established a comprehensive system for the management of solid waste in New Jersey. The Act designated all twenty-one (21) of the state's counties, and the Hackensack Meadowlands District, as Solid Waste Management Districts, and mandated the respective Boards of Chosen Freeholders and the Meadowlands Development Commission develop comprehensive plans for waste management in their respective districts. On January 29, 1981, the New Jersey Department of Environmental Protection (NJDEP) approved, with modifications, the Morris County District Solid Waste Management Plan (Plan). The Act further requires that all new solid waste facilities be approved for Plan inclusion.

This document has been prepared to amend the Plan to include the County Concrete Corp. class B concrete recycling facility in Roxbury Township, Morris County, New Jersey within the Plan.

## **Site Description**

County Concrete Corp currently operates a ready mixed concrete plant and aggregate (stone, sand and gravel) production facility at 50 Railroad Avenue in the Kenvil section of Roxbury Township, Morris County, New Jersey. It should be noted that County Concrete's aggregate and mixed concrete production facility is located on both lots 1 & 2 on block 2501 in Roxbury Township and this is not a regulated solid waste activity. The regulated class B recycling facility will be situated exclusively on the 49.5 acre lot 1 on block 2501 and of which, approximately 20% will be used for the recycling operation. The lot1/lot2 property line shall be physically demarcated on the site to verify that lot 2 is not encroached upon by the "Unprocessed Stockpile." Figure 1 is a tax map providing the site location and boundaries.

## **Source Area**

The County Concrete Corp. class B recycling facility will operate as a merchant facility open to the public. It is estimated that between 65%-75% of the recyclable material accepted will be by-products of County Concrete's existing concrete business. The remaining 25%-35% of materials accepted will be materials brought in by County Concrete's customers. There are no restrictions placed on the source areas generating the material that can be accepted by County Concrete Corp. The Township of Roxbury shall be provided access to bills of lading for incoming concrete or masonry products other than those generated by County Concrete Corp.

## **Type of Material**

The only materials accepted at the facility will be source separated class B recyclables limited to concrete and concrete brick/block. These recyclable concrete materials will be required to be source separated from garbage prior to delivery to the facility. Contamination levels should not represent more than approximately 1% of the incoming material by volume. The facility will not be permitted to accept other class B materials other than concrete and concrete brick /block. As such, the County Concrete's facility will not accept asphalt, wood or brick (non-concrete). Any residue requiring disposal will be delivered to the Morris County transfer station in Mount Olive in accordance with the flow control requirements of the Morris County Solid Waste Management Plan.

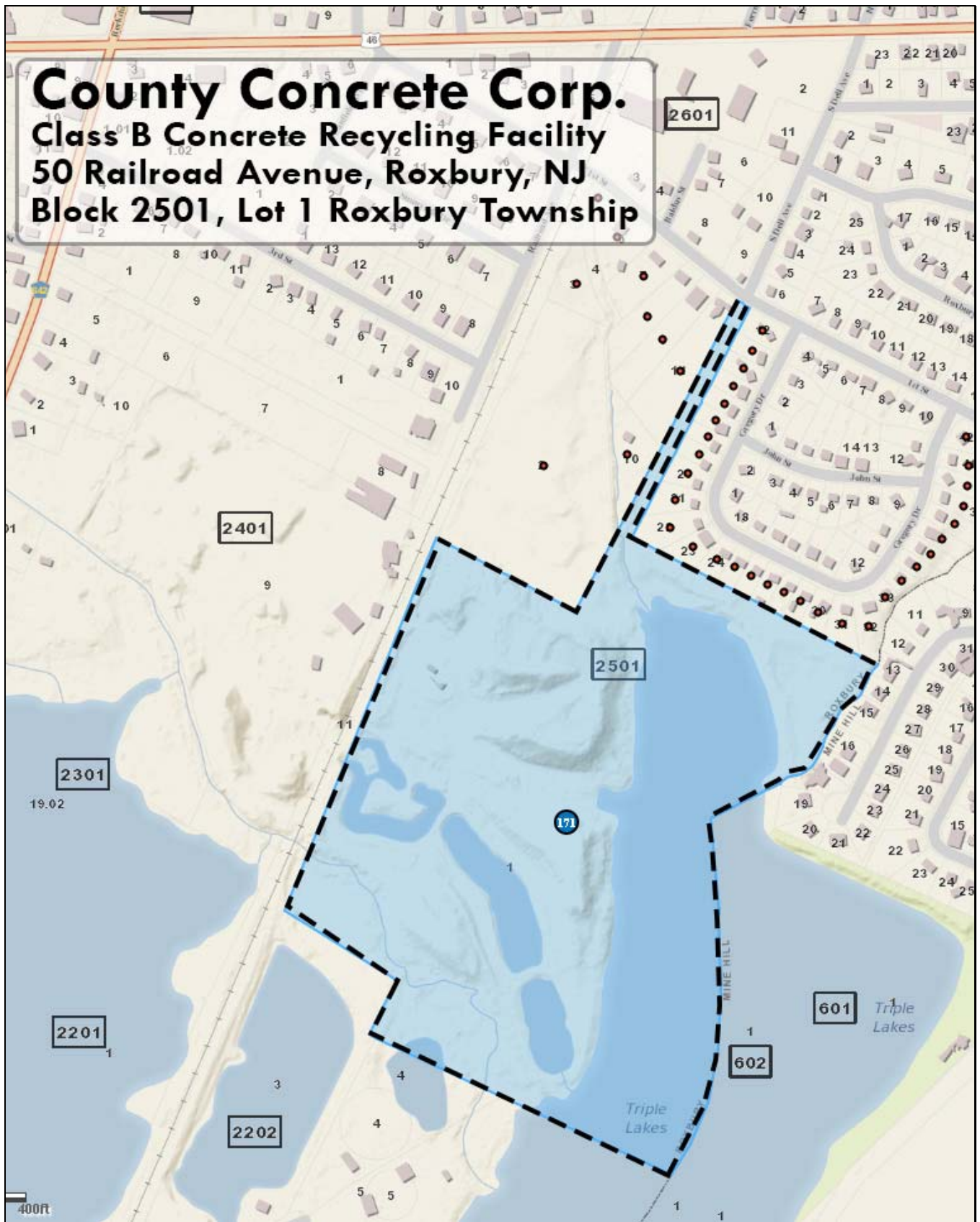

Figure 1 County Concrete Tax Map - block 2501, lot 1, Roxbury Township, NJ

## **Facility Capacity**

The daily capacity for the acceptance of class B materials described above is 2,500 tons per day.

## **Materials Handling and Process Flow**

**Material Handling:** County Concrete will process the left-over material it produces, as well as that accepted from third parties, into recycled concrete aggregate (“RCA”). Material will be processed (crushed/pulverized) to meet the standards and gradations specifications set forth by NJDOT.

All materials being dropped off will be inspected both at the entrance point to the plant as well as during unloading. Unsuitable material discovered during unloading will be reloaded and removed.

Processed and unprocessed stockpiles of materials shall not exceed a maximum height of 30 feet. Pile markers utilized in delineating the stockpile boundaries shall be identified and easily recognizable in the field. A 60-foot wide angle of repose shall be depicted along the northerly boundary of the “Unprocessed Stockpile” and stockpiling volumes shall be adjusted accordingly. Any encroachment of the unprocessed stockpile perimeter road or unprocessed stockpile material noticed on lot 2 shall be rectified by immediate removal from lot 2.

RCA is used as a base on many road and highway projects and as a supplemental aggregate in new concrete productions. The market for recycled products has dramatically increased for County Concrete with the expansion of the green movement. As such, customers are demanding more RCA instead of purchasing processed stone.

It is County Concrete’s responsibility to re-grade and maintained the shoulder along the railroad side of Railroad Avenue so it is below the road edge elevation to permit sheet flow downhill through the grass toward the swale that runs parallel to the railroad tracks.

## **Traffic**

It is anticipated that the source separated class B materials delivered to the site will arrive via tandem load trucks. It is estimated that an approximate maximum of 4 trucks per day will deliver class B materials. This equates to less than one additional truck per hour considering the site’s 10-12 hour working day. Given that this is already a large, established construction materials facility with numerous trucks carrying aggregate materials and ready mixed concrete, the increase in truck traffic will be small; estimated to be an 8% increase.

## **Hours of Operation**

The facility’s maximum hours of acceptance of materials and operation shall be:

- Monday – Friday – 7:00 A.M. – 7:00 P.M, Saturdays – 7:00 A.M. – 12:00 P.M.
- Sundays and legal holiday - Closed

## **Access To The Facility**

County Concrete Corp. shall grant access to designated representatives of the Morris County Solid Waste Advisory Council, Morris County Municipal Utilities Authority, Morris County Office of Health Management, Roxbury Township, Certified County Lead Agency from any county that waste is received from, Local Health Department, and the New Jersey Department of Environmental Protection for the purpose of inspection of site operations and waste management records.

## **Municipal Input**

Appendix A is a copy of Resolution No. 2013-153 adopted by Roxbury Township on June 11, 2013 providing support for including the County Concrete Corp. class B recycling facility in the Plan. The adoption of this resolution providing host municipal endorsement regarding the Plan inclusion of the facility was predicated on the inclusion of certain terms and conditions as contained in the resolution. These terms and conditions have been incorporated into the text of this Plan Amendment where appropriate. All the terms and conditions included in the Roxbury Township resolution, as denoted in the list of items “a” through “n,” shall be incorporated and included as part of this Plan amendment as if they were included directly as text.

## **Plan Amendment**

Pursuant to N.J.S.A. 13:1E-1 *et. seq.* Morris County proposes to include the class B processing operation owned and operated by County Concrete Corp., Township of Roxbury (block 2501, lot 1), Morris County, New Jersey into the Morris County Solid Waste Management Plan. A map illustrating the site location has been included in Figure 1.

This proposed plan amendment is in conformance with the approved Plan by providing for the management of solid wastes generated in Morris County.

To insure the broadest possible participation by the general public in this plan amendment process, the Morris County Board of Chosen Freeholders will conduct a public hearing. All County residents, public officials or organizations interested in this action are encouraged to attend the public meeting and offer testimony.

Inquiries and written comments or questions concerning this proposed plan amendment may be addressed to:

Morris County Board of Chosen Freeholders  
P.O. Box 900  
Morristown, New Jersey 07963-0900

Morris County Municipal Utilities Authority  
P.O. Box 370  
Mendham, New Jersey 07945-0370



# Township of Roxbury

1715 Route 46  
Ledgewood, NJ 07852  
www.roxburynj.us

RECEIVED

JUN 20 2013

MCMUA

Information  
973-448-2000

Building & Construction  
973-448-2009

Court  
973-448-2034

Engineer  
973-448-2018

Finance  
973-448-2006

Fire Official  
973-448-2012

Health  
973-448-2028

Manager  
973-448-2002

Mayor and Council  
973-448-2001

Police  
973-448-2100

Planning and Zoning  
973-448-2008

Public Works  
973-448-2069

Recreation  
973-448-2015

Tax Assessor  
973-448-2021

Tax Collector and Utilities  
973-448-2022

Technology  
973-448-2099

Township Clerk  
973-448-2001

Sewer Plant  
973-584-5360

Water Plant  
973-398-2818

June 17, 2013

Morris County MUA  
PO Box 370  
Mendham, NJ 07945-0370

**RE:** Resolution No. 2013-153, "RESOLUTION CONSENTING TO THE INCLUSION OF COUNTY CONCRETE CORPORATION'S CLASS "B" CONCRETE RECYCLING FACILITY IN THE MORRIS COUNTY SOLID WASTE MANAGEMENT PLAN UNDER CERTAIN CONDITIONS", adopted by the Township Council of the Township of Roxbury on June 11, 2013.

Dear Sir/Madam:

Enclosed please find a copy of the above-referenced resolution outlining recommendations to be incorporated into any plan amendment prior to the inclusion of County Concrete's Class "B" Recycling Facility into the Morris County Solid Waste Management Plan.

If you have any questions regarding this correspondence, please feel free to call the Township of Roxbury at 973-448-2000.

Sincerely,

TOWNSHIP OF ROXBURY

Amy E. Rhead  
Township Clerk

/aer

Enclosures

cc: **Morris County Solid Waste Advisory Council**  
County Concrete Corporation  
Russell Stern, Township Planner  
Michael Kobylarz, Township Engineer  
Rick Blood, Director of Public Works  
Anthony M. Bucco, Township Attorney

2011 "America's Promise Alliance 100 Best Communities for Young People"



**RESOLUTION NO. 2013 – 153**

**A RESOLUTION CONSENTING TO THE INCLUSION OF  
COUNTY CONCRETE CORPORATION'S CLASS "B" CONCRETE  
RECYCLING FACILITY IN THE MORRIS COUNTY SOLID WASTE  
MANAGEMENT PLAN UNDER CERTAIN CONDITIONS**

**WHEREAS**, the County of Morris received an application and proposal from County Concrete Corporation ("County Concrete") for a Class "B" Concrete Recycling Facility at County Concrete's existing aggregate production plant located at 50 Railroad Avenue, Block 2501, Lot 1; and

**WHEREAS**, by letter dated January 22, 2013, the Morris County Municipal Utilities Authority requested that the Township review County Concrete's application and proposal and adopt a resolution setting forth its position relative to the inclusion of the proposed recycling facility in the County's Solid Waste Management Plan; and

**WHEREAS**, the application and proposal filed by County Concrete would allow for the recycling of concrete and masonry products into a recycled aggregate product ("RAP") at its existing plant; and

**WHEREAS**, the New Jersey Department of Environmental Protection previously issued a "Limited (Temporary) Class "B" Recycling Facility Approval" for Block 2501, Lot 1 to process on-site generated concrete and block material to produce RAP for sale to third parties; and

**WHEREAS**, the proposed recycling facility will be wholly contained within Block 2501, Lot 1; and

**WHEREAS**, County Concrete has agreed that it will not accept asphalt, wood or brick product at the proposed recycling facility; and

**WHEREAS**, County Concrete's proposal and application were reviewed by the Township Planner, Russell Stern, AICP, PP, LLA and in a memorandum dated March 19, 2013 ("Memorandum") (a copy of which is attached hereto and made a part hereof), Mr. Stern recommended approval of the application subject to various conditions and plan revisions; and

**WHEREAS**, the Memorandum is also provided for reference by the Morris County Solid Waste Advisory Council for implementation of the recommended plan revisions; and

**WHEREAS**, the Township Council has reviewed the Township Planner's memorandum and wishes to approve of the proposed recycling facility subject to the conditions and plan revisions set forth in Mr. Stern's memorandum.

rtres13-15  
BUCCO



**NOW, THEREFORE, BE IT RESOLVED**, by the Township Council of the Township of Roxbury, in the County of Morris and State of New Jersey as follows:

1. The Township Council hereby supports and consents to the inclusion of County Concrete's proposed Class "B" Concrete Recycling Facility to be located at 50 Railroad Avenue, Block 2501, Lot 1 into the Morris County Solid Waste Management Plan subject to the following terms and conditions:

- a. The recycling facility shall be wholly contained within Block 2501, Lot 1.
- b. The recycling facility shall not accept asphalt, wood or brick product.
- c. The hours of operation of the recycling facility shall be from 7:00 a.m. to 7:00 p.m. weekdays and 7:00 a.m. to 12:00 p.m. on Saturdays. The facility shall be closed on Sundays and legal holidays.
- d. Processed and unprocessed stockpiles of materials shall not exceed a maximum height of 30 feet.
- e. The designated truck route shall be entering the site from Route 46 to Railroad Avenue and exiting the site from Railroad Avenue to Route 46.
- f. The shoulder along the railroad side of Railroad Avenue will be re-graded and maintained below the road edge elevation to permit sheet flow downhill through the grass toward the swale that runs parallel to the railroad tracks.
- g. A copy of the facility's Dust Management Plan shall be provided to the Township Engineer and Department of Public Works Director prior to the commencement of operations and shall be subject to the Township's approval.
- h. The Lot 1/Lot 2 property line shall be physically demarcated to verify that Lot 2 is not encroached upon by the "Unprocessed Stockpile." The unprocessed stockpile perimeter road and any unprocessed stockpile material shall be removed from Lot 2.
- i. Pile markers utilized in delineating the stockpile boundaries shall be identified and easily recognizable in the field.

rtres13-15  
BUCCO

✓

- j. A 60 foot wide angle of repose shall be depicted along the northerly boundary of the "Unprocessed Stockpile". Stockpile volume shall be adjusted accordingly.
- k. Block 2501, Lot 1 shall be correctly identified as the proposed Class "B" Concrete Recycling Facility on the Tax Map and Zoning Map depicted on Sheet 1.
- l. The Township shall be provided access to the Bills of Laden for incoming concrete or masonry products other than those generated by County Concrete Corporation.
- m. The Township shall be copied on any application and plan revisions.
- n. Prior to accepting incoming concrete or masonry products from outside vendors, County Concrete Corporation will obtain all necessary permits and/or approvals from Morris County and/or the State of New Jersey.

**BE IT FURTHER RESOLVED**, that the Township Clerk is hereby authorized and directed to forward a certified copy of this Resolution to the Morris County Municipal Utilities Authority and the **Morris County Solid Waste Advisory Council** indicating its approval and recommending that the conditions set forth in this Resolution be incorporated into any plan amendment prior to the inclusion of County Concrete's Class "B" Recycling Facility into the Morris County Solid Waste Management Plan. A copy of this Resolution shall also be provided to the Township Planner, Russell Stern; Township Engineer, Michael Kobylarz; Director of Public Works, Rick Blood; Township Attorney, Anthony M. Bucco; and County Concrete Corporation.

This Resolution shall take effect immediately.

**ADOPTED:** June 11, 2013

Attest:

  
Amy E. Rhead  
Township Clerk

rtres13-15  
BUCCO